

MAUNAWAI® PICONNECT

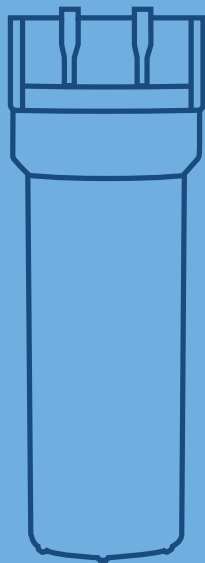

# PiTec

EN

Assembly and  
operating instructions

## TABLE OF CONTENTS

- 3 | Technical data
- 4 | The PiTec filters
- 6 | **SCOPE OF DELIVERY**
- 7 | **INSTALLATION AND COMMISSIONING**
- 8 | **INSTALLATION INSTRUCTIONS**
- 10 | **MAINTENANCE**
- 10 | **CHANGE INTERVALS**
- 10 | Guarantee
- 12 | Change interval table
- 14 | Contact

## Technical data

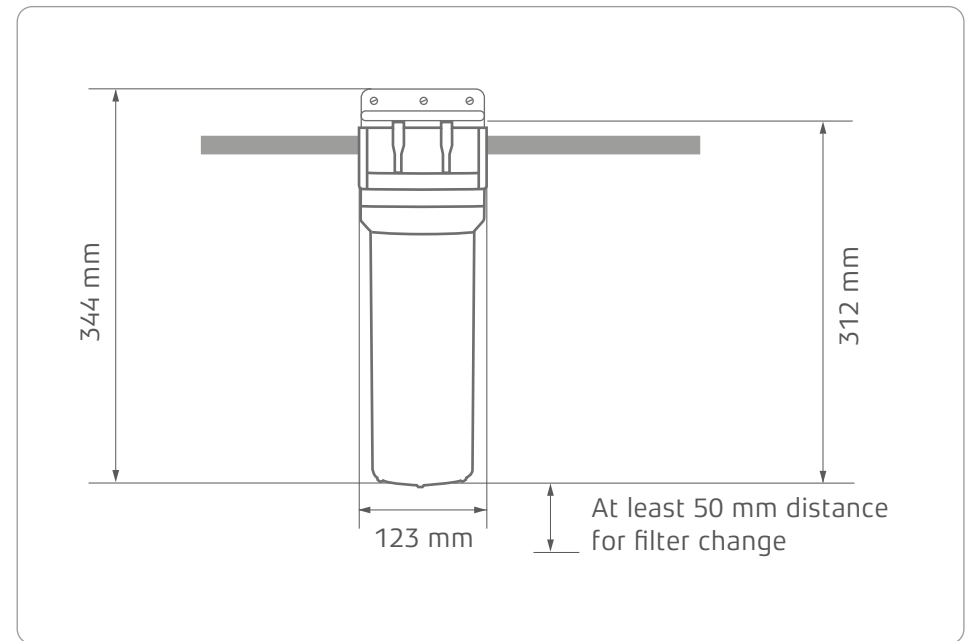

### PiTec housing (1 unit)

**Overall height:** 312 mm  
344 mm (up to upper edge  
of vent valve)

**Installation depth  
with wall bracket:** 150 mm

**Diameter:** 123 mm  
157 mm (housing head with  
connection nipple)

**Empty weight:** 1.5 kg

**Connection:** 3/8" (inch)

## THE PITEC FILTERS



### Chemical-free limescale protection

*Without salt tablets*

*Without power*

The limescale filter cartridge uses ceramic granulate with a specially coded surface to initiate the process of heterogeneous catalysis. A similar process can be observed in nature in mussels and corals.

The tap water flows around the granulate. Small, so-called „seed crystals“ of a few ten-thousandths of a millimetre form automatically and within seconds on the granulate surface. The seed crystals floating in the water are carried into all pipes and connected devices. They trap the limescale so that it does not adhere to the treated water.

The water is not changed in its chemical composition. Since the minerals in the water are preserved, the measured value of TDS devices may not change.

Renovation of old installations and boilers is possible in just a few months, as existing calcifications are also slowly detached and carried along in a gentle process.

Chemical-free limescale protection is a recognised biotechnology.



#### Two-stage sediment filter made of polypropylene foam

The MAUNAWAI® basic filter has three times the dirt-holding capacity of conventional filter cartridges of similar size. Ideal for removing the following impurities from the water:

- Sand
  - Mud
  - Rust
  - Pollen
- and other suspended solids



#### Chemical-free limescale protection thanks to biotechnology

Filter material: ceramic granulate with a special surface, similar to mussels and corals.

Advantages

- Minerals are retained in the water
- The water remains chemically unchanged
- Without salt tablets
- Without ion exchanger
- Without power



#### Carbon block filter made of activated carbon.

The water pressure decreases by only approx. 0.5 bar despite the high fineness of the filter cartridge. Ideal for removing the following impurities from your water:

- Odours and bad taste in water
- Restraint of chlorine and similar undesirable substances
- Retention of various heavy metals such as lead etc
- Restraint from organic compounds



#### The PI filter cartridge was specially developed for the MAUNAWAI® water filter system and offers an especially high quality.

Advantages:

- pH value increases
  - Emits oxygen
  - Antibacterial effect
  - Stabilises the water
  - Fine clustering
  - Releases minerals and trace elements (TDS value increases)
- Filter material: combination of over 20 different ceramic balls



combines filters 2 and 4

## SCOPE OF DELIVERY

Before assembling MAUNAWAI® PiTec, please check with the help of the illustration whether all components are present.



1 Housing with reducing nipples mounted

2 Filter cartridge

3 A Set consisting of  
· 1 wall bracket  
· 4 stainless steel screws

4 1 housing spanner for opening/closing the housing

### Not including in the scope of supply:

Additional flex connecting hose 3/8" internal thread x 3/8" internal thread in the necessary length

3 screws for walls mounting

## INSTALLATION AND COMMISSIONING

Work on the drinking water pipe must be carried out by a specialist plumber.

- Loosen the union nut of the cold water pipe on the angle valve.

Local regulations, general guidelines (e.g. WVU, EVU, VDE, ÖVE, DIN, DVHW, ÖVGW, SVGW), the technical data and installation and safety regulations must be observed.

MAUNAWAI® PiTec is mounted on the cold water pipe under the sink.

### To prepare for assembly, please note:

- Make sure you have received the desired cartridge. Compare the pictures on page 14.

- Determine the installation position in the horizontal course of the cold water pipe in the pressure direction

- Shut off the water supply (angle valve) for the cold water pipe and open your tap to drain the residual water.

## INSTALLATION INSTRUCTIONS

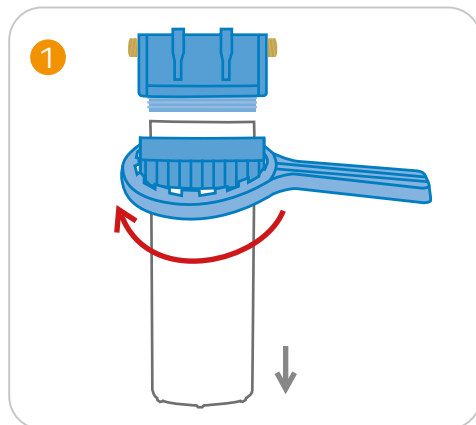

1 Unscrew the bottom part of the filter housing from the housing head using the housing key.

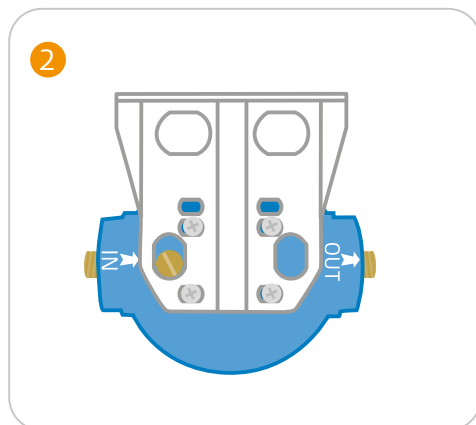

2 Screw the wall bracket onto the filter housing head using the 4 flat stainless steel screws.

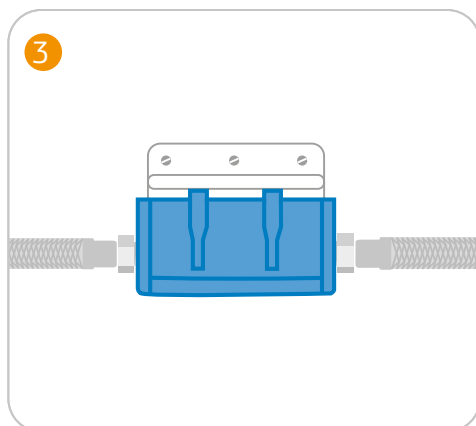

3 Attach the pre-assembled system to the wall and integrate it into the cold water pipe. To do this, connect the union nuts of the additional flexible connection hose to the angle valve and the inlet to the housing head (IN). Now connect the union nut of the loosened flexible hose (fitting) to the outlet of the housing head (OUT).

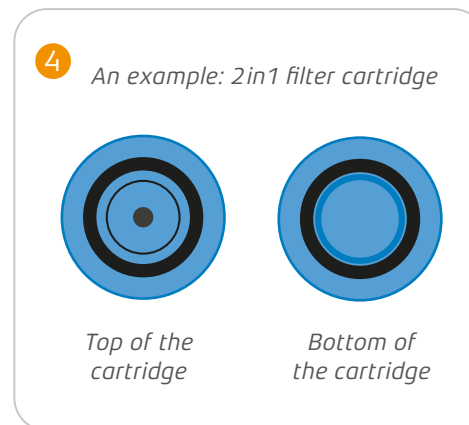

4 Select the top of the cartridge before inserting the filter cartridge.

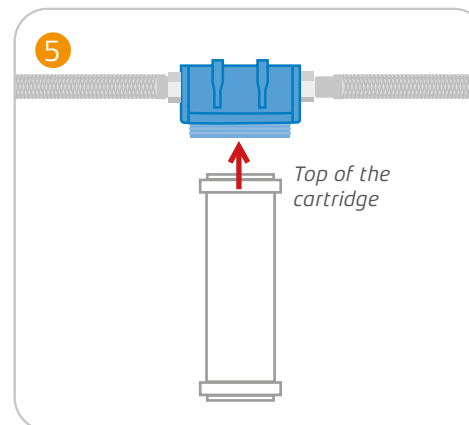

5 With its opening upwards, insert the cartridge into the housing head.

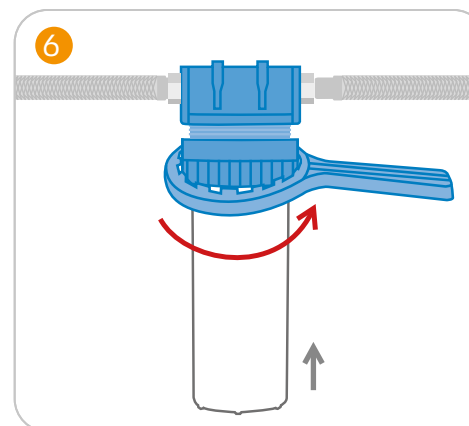

6 Reconnect the lower part of the housing, including the cartridge, with the housing and tighten using the housing spanner. Make sure that the sealing rings are seated correctly.

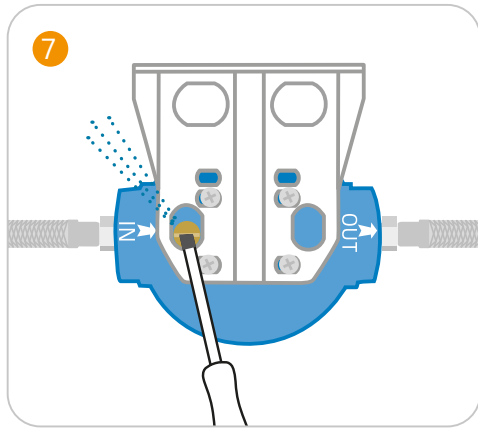

Allow water into the filter system by opening the angle valve.

Open the bleed valve on the housing cover and allow air to escape until water appears. The bleed valve can now be closed.

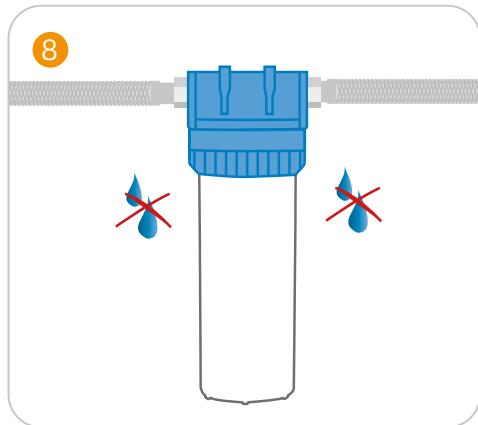

Further bleed the pipe by opening the tap.

Check that all connections are tight fitting. To do this, use a dry cloth to wipe dry the connection points from below and wait a few minutes.

If these points remain dry, the system is ready for operation.

## MAINTENANCE

The filter cartridges should be replaced regularly, depending on the water quality, according to the change intervals.

The replacement is simple and can be carried out by yourself with the supplied housing key and the enclosed instructions.

### Note

Only suitable for cold water operation!

Do you have any further questions?

Write us an

E-mail: [info@maunawai.com](mailto:info@maunawai.com)

or give us a call.

## CHANGE INTERVALS

### Basic filter:

approx. 12 months

### Intensive filter:

approx. 12 months

### Limescale filter:

approx. 3 years

### PI filter:

approx. 3-5 years

### 2in1 filter:

approx. 12 months

## GUARANTEE

MAUNAWAI GmbH provides a 24-month warranty for the components/modules if they are installed correctly.

Our customer service must be given the opportunity to rectify or replace the product.

# MAUNAWAI® REPLACEMENT INTERVALS

## 1 Basic filter

Service life:  
approx. 12 months

Used from:

## 2 Intensive filter or 5 2in1

Service life:  
approx. 12 months

Used from:

## 3 Limescale filter

Service life:  
approx. 3 years

Used from:

## 4 PI filter

Service life:  
approx. 3–5 years

Used from:



## CONTACT

MAUNAWAI GmbH  
Adolf-Damaschke-Straße 69–70  
D-14542 Werder (Havel)  
Germany  
✉ info@maunawai.com  
☎ +49 3327 570880 · 📞 0151 64879605

*Or contact the sales partner from whom you purchased the MAUNAWAI® water filter system.*

**Ihr MAUNAWAI® Händler**

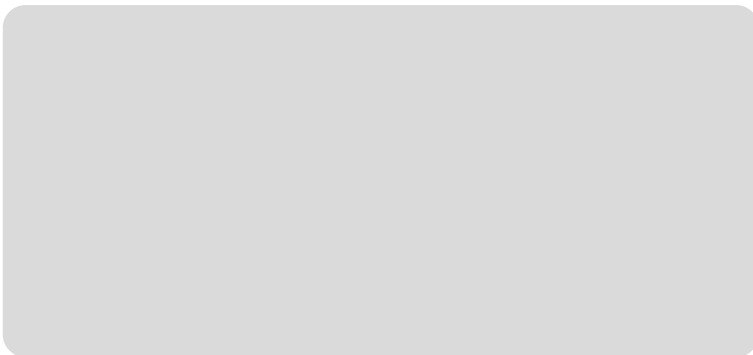

B-U-77-02-en

**[www.maunawai.com](http://www.maunawai.com)**