

MAUNAWAI® PICONNECT

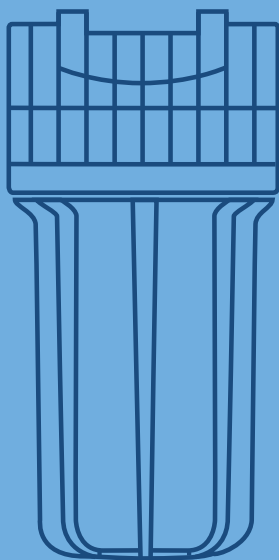

EN

Peka

Assembly and
operating instructions

TABLE OF CONTENTS

- 3 | Technical data
- 4 | The PEKA filters cartridges
- 6 | **SCOPE OF DELIVERY**
- 7 | **INSTALLATION AND COMMISSIONING**
- 8 | **INSTALLATION INSTRUCTIONS**
- 11 | **MAINTENANCE**
- 11 | **CHANGE INTERVALS**
- 11 | Guarantee
- 12 | Change interval table
- 14 | Contact



Technical data

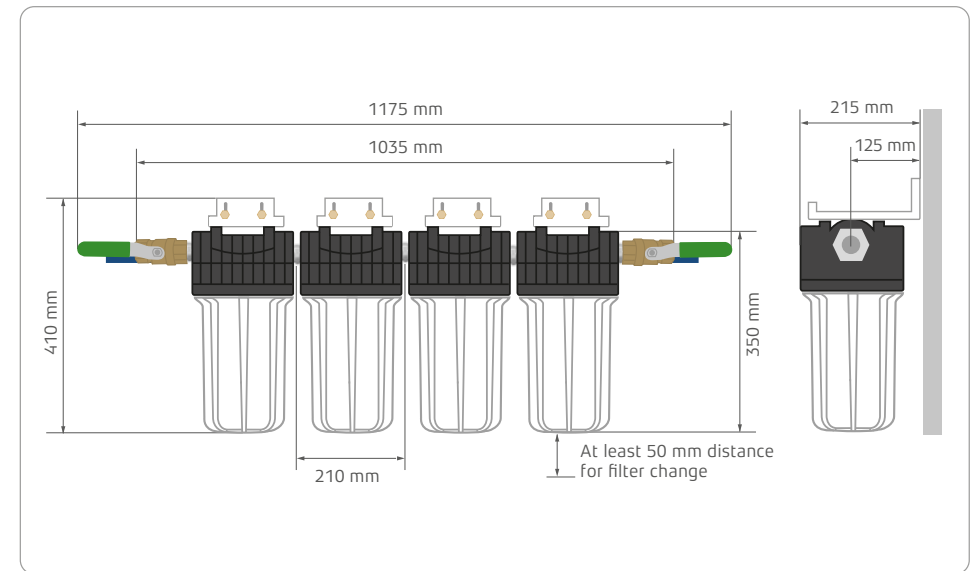

Peka 10" housing (1 unit)

Total height: 350 mm
(up to upper edge of vent valve)

Diameter: 185 mm
(housing head with connection nipple)

for 4 units approx. 1.20 m
Empty weight: 2,63 kg
Connection: 1" (inch)
Throughput: 30 l / min
Capacity: approx. 120,000 litres*.

Peka 20" housing (1 unit)

Total height: 620 mm
(up to upper edge of vent valve)

Diameter: 185 mm
(housing head with connection nipple)

for 4 units ca. 1,20 m
Empty weight: 3,4 kg
Connection: 1" (inch)
Throughput: 60 l / min
Capacity: approx. 120,000 litres*.

*Depending on water pressure

THE PEKA FILTER CARTRIDGES



The white and black sealing ring distinguishes anti-limescale and PI filters from the top.

Chemical-free limescale protection

Without salt tablets

Without power

The limescale filter cartridge uses ceramic granulate with a specially coded surface to initiate the process of heterogeneous catalysis. A similar process can be observed in nature in mussels and corals.

The tap water flows around the granulate. Small, so-called „seed crystals“ of a few ten-thousandths of a millimetre form automatically and within seconds on the granulate surface. The seed crystals floating in the water are carried into all pipes and connected devices. They trap the limescale so that it does not adhere to the treated water.

The water is not changed in its chemical composition. Since the minerals in the water are preserved, the measured value of TDS devices may not change.

Renovation of old installations and boilers is possible in just a few months, as existing calcifications are also slowly detached and carried along in a gentle process.

Chemical-free limescale protection is a recognised biotechnology.



1 Basic filter

Two-stage sediment filter made of polypropylene foam

The MAUNAWAI® basic filter has three times the dirt-holding capacity of conventional filter cartridges of similar size.

Ideal for removing the following impurities from the water:

- Sand
 - Mud
 - Rust
 - Pollen
- and other suspended solids



2 Intensive filter

Carbon block filter made of activated carbon. The water pressure decreases by only approx. 0.5 bar despite the high fineness of the filter cartridge.

Ideal for removing the following impurities from your water:

- Odours and bad taste in water
- Restraint of chlorine and similar undesirable substances
- Retention of various heavy metals such as lead etc
- Restraint from organic compounds



3 Limescale filter

Chemical-free limescale protection thanks to biotechnology

Filter material: ceramic granulate with a special surface, similar to mussels and corals.

Advantages

- Minerals are retained in the water
- The water remains chemically unchanged
- Without salt tablets
- Without ion exchanger
- Without power



4 PI filter

The PI filter cartridge was specially developed for the MAUNAWAI® water filter system and offers an especially high quality.

Advantages:

- pH value increases
 - Emits oxygen
 - Antibacterial effect
 - Stabilises the water
 - Fine clustering
 - Releases minerals and trace elements (TDS value increases)
- Filter material: combination of over 20 different ceramic balls

SCOPE OF DELIVERY

Before assembling MAUNAWAI® Peka, please check with the help of the illustration whether all components are present.

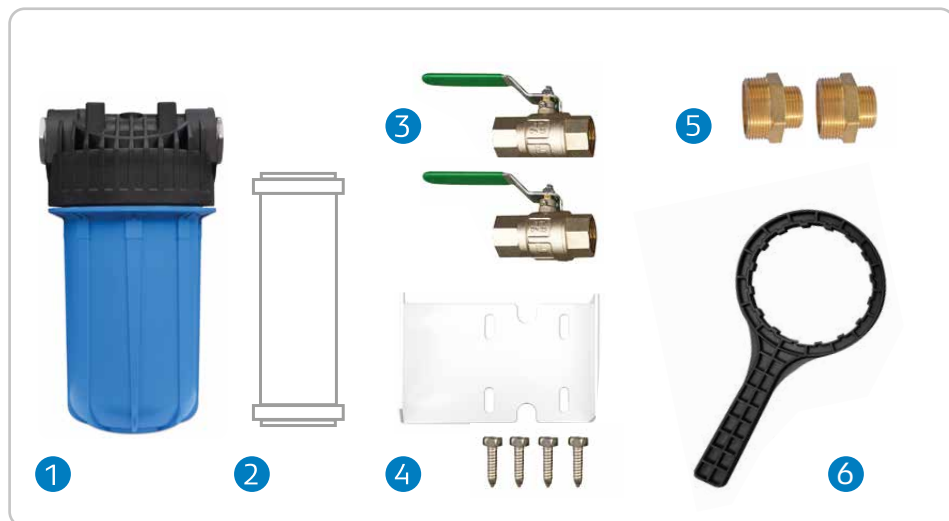

- 1 Case
- 2 Filter cartridge
- 3 2 ball valves
- 4 1 wall bracket per housing with one set of 4 stainless steel screws per enclosure for attaching the wall bracket to the housing (screws and wall plugs for the wall are not included)
- 5 2x 1 1/2" | 1" double reducing nipples for connection to the ball valves
- 6 1 housing key for opening/closing the housings
- 7 Option: Includes 1" double nipples for linking two or more cases

INSTALLATION AND COMMISSIONING

Work on the drinking water pipe must be carried out by a specialist plumber.

Local regulations, general guidelines (e.g. WVU, EVU, VDE, ÖVE, DIN, DVHW, ÖVGW, SVGW), the technical data and installation and safety regulations must be observed.

We draw particular attention to the necessary earthing of the water pipe (potential equalisation).

The use of a pressure reducer is recommended.

Please note that the max. pressure load of the Peka housing is 4.5 bar continuous load.

In the case of a municipal domestic water connection, a system separator up to FK-4 in accordance with DIN EN 1717/DIN 1988.100 must be installed upstream of the filter system, if prescribed.

Ask your installer about this.

The Peka modules are installed in the drinking water pipe down-

Use **hemp** to seal the housing heads!



stream of the water meter and any house filter using the screw connections supplied.

If the existing pipe size differs from the connection size of the fitting, the transition must be made with an additional commercially available sleeve made of brass or stainless steel.

For optimal operation, ensure that the additional weight of the Peka module is supported by existing suitable or additional pipe supports.

INSTALLATION INSTRUCTIONS

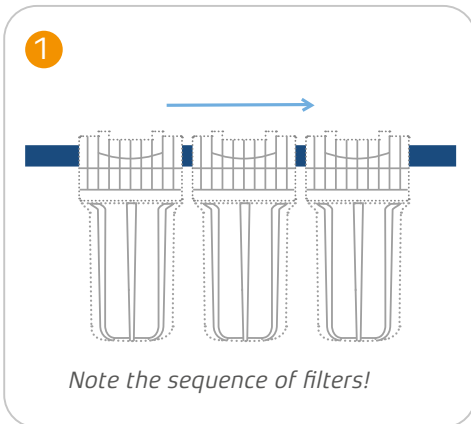

Determine the installation position in the horizontal course of the drinking water pipe in the direction of pressure. Make the pipe opening of the appropriate size (observe the dimensions of the filter system). Observe the wall distance to the centre of the pipe.

Sequence of filters in flow direction: 1. basic filter, 2. intensive filter, 3. limescale protection, 4. PI filter

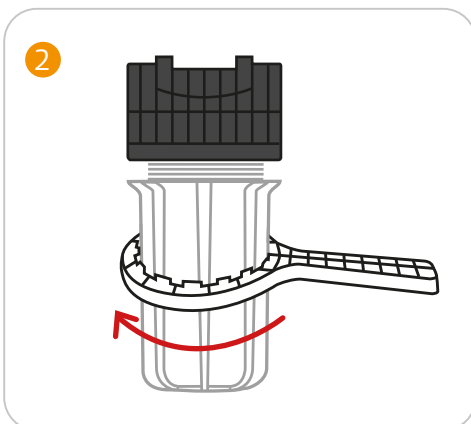

Unscrew all lower parts of the filter housings from the housing heads using the housing key.

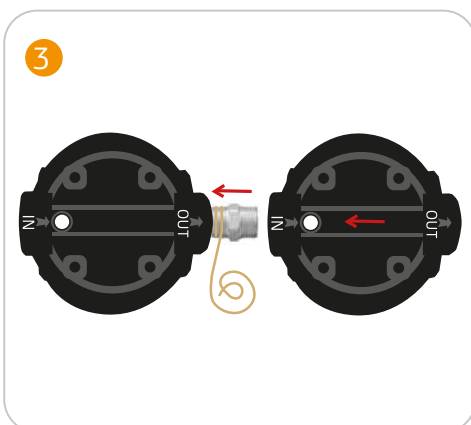

Connect the housing heads with the help of the double nipples and tighten them firmly. (recommended to use **hemp**)

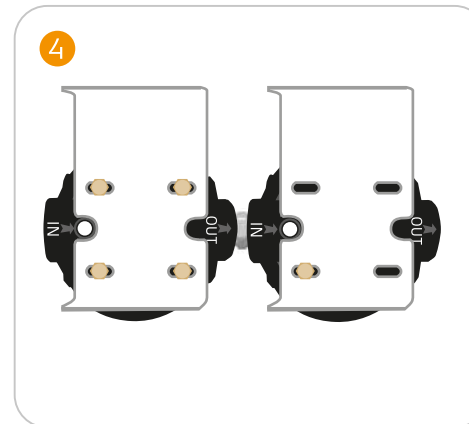

Screw the wall brackets onto the filter housing heads with the 4 stainless steel screws.

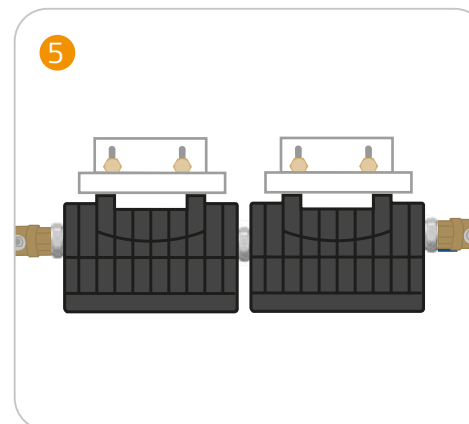

Install ball valves in front of and behind the system. The valve behind the system is mandatory when changing the filter later!

Attach the pre-assembled system to the wall and connect it to the cold-water pipework.

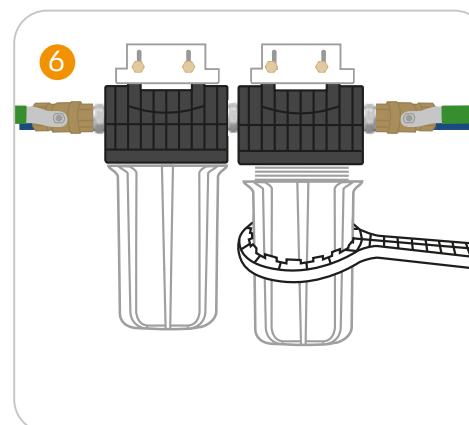

Reconnect the lower housing parts to the housing heads and tighten them with the housing key.

MAINTENANCE

The filter cartridges should be replaced regularly, depending on the water quality, according to the replacement intervals.

The replacement is simple and can be carried out by yourself with the supplied housing key and the enclosed instructions.

Note

Only suitable for cold water operation!

Do you have any further questions?

Write us an
E-mail: info@maunawai.com
or give us a call.

CHANGE INTERVALS

Basic filter:

approx. 12 Monate

Intensive filter:

approx. 12 Monate

Limescale filter:

approx. 3–5 Jahre

PI filter:

5 Jahre

WARRANTY

MAUNAWAI GmbH provides a 24-month warranty for the components/modules if they are installed correctly.

Our customer service must be given the opportunity to rectify or replace the product.

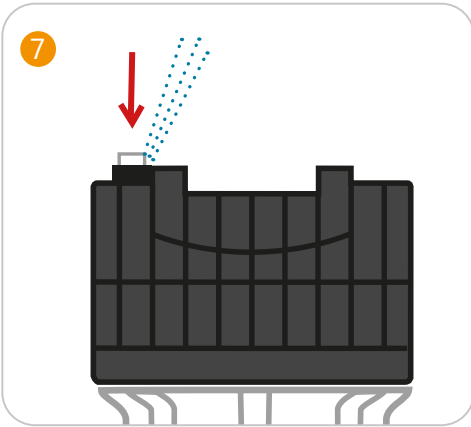

Let water into the mains by opening the main valve behind the water meter.

Open the small vent valve on the housing cover and let the air escape until the water appears. The vent valve can now be closed.

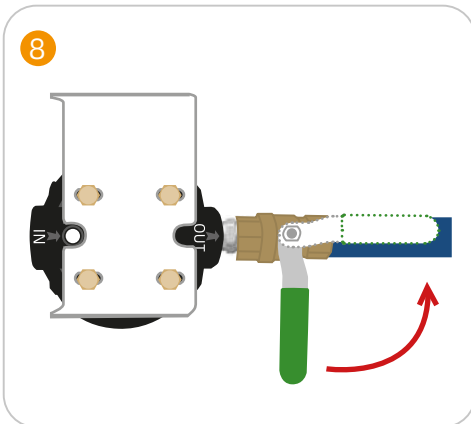

Now open the valve on the other side of the connection block (outlet side).

Continue to bleed the line if necessary. (See point 7)

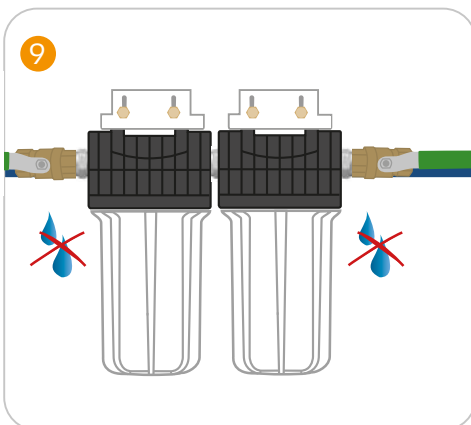

Check whether all connections of the assembly are tight. To do this, rub the connection spots dry from below with a dry cloth and wait a few minutes.

If the spots remain dry, the system is ready for operation.

MAUNAWAI® REPLACEMENT INTERVALS

1 Basic filter

Service life:
approx. 12 months

Used from:

2 Intensive filter

Service life:
approx. 12 months

Used from:

3 Limescale filter

Service life:
approx. 3–5 years

Used from:

4 PI-Filter

*Service life:
approx. 5 years*

Used from:



CONTACT

MAUNAWAI GmbH
Adolf-Damaschke-Straße 69–70
D-14542 Werder (Havel)
Germany
✉ info@maunawai.com
☎ +49 3327 570880

*Or contact the sales partner from whom you purchased
the MAUNAWAI® water filter system.*

Ihr MAUNAWAI® Händler

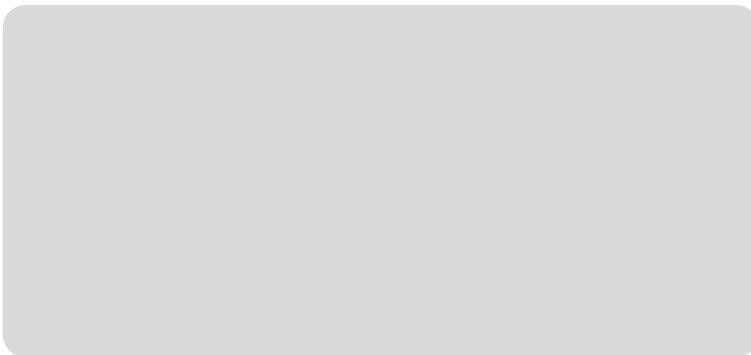

B-U-72-08-en

www.maunawai.com